



SHIMAI
HARDWARE

SINCE
2004

Bolts and Nuts

BOLTS & NUTS & WASHERS

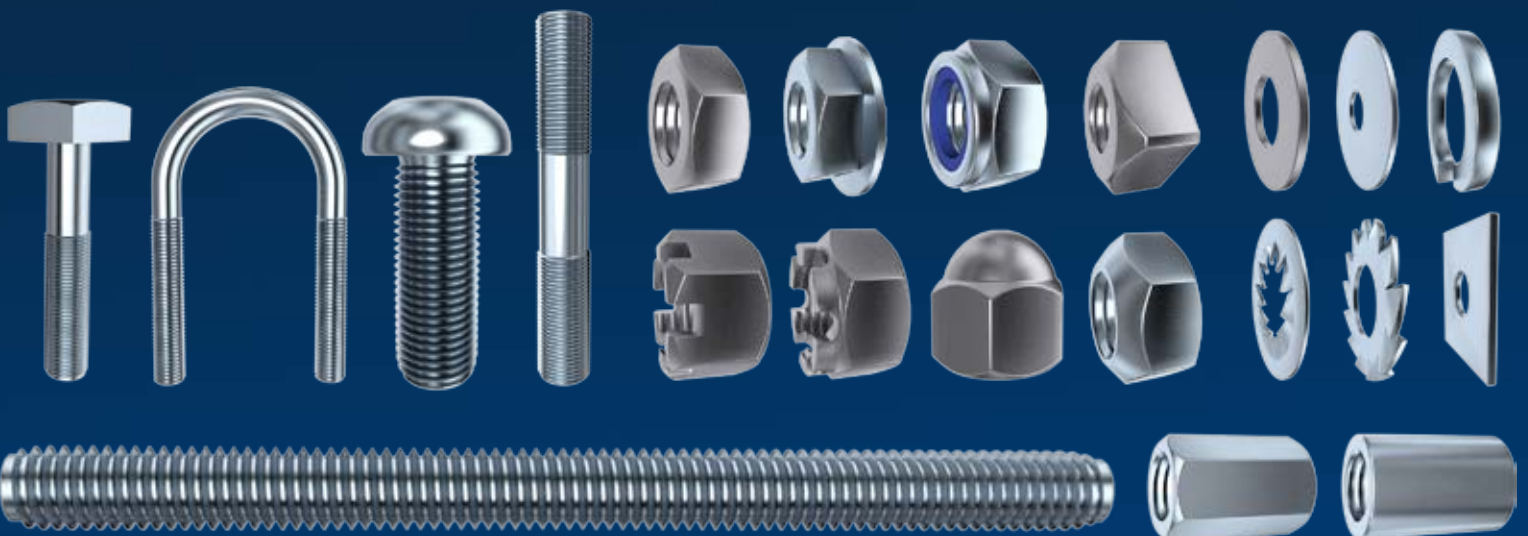
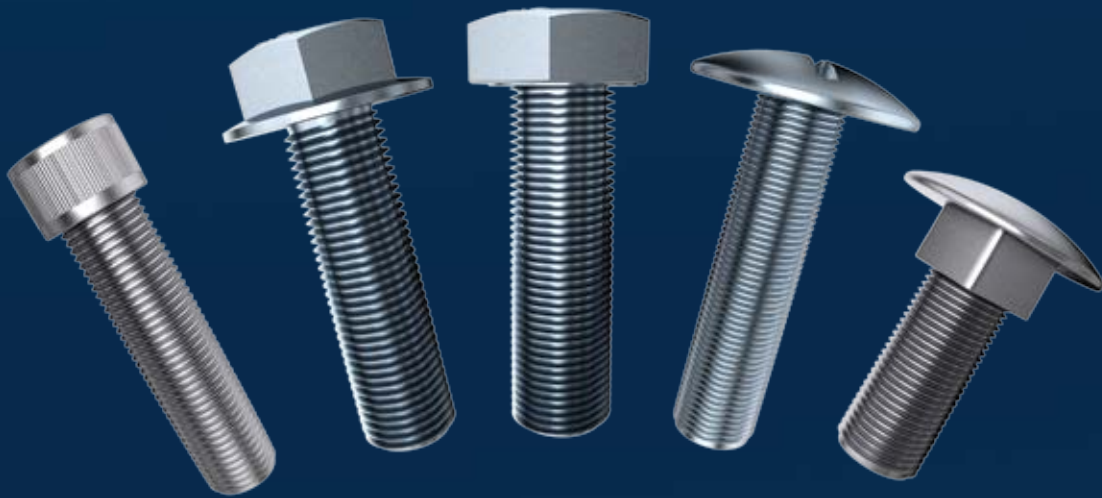

Index

Bolts and Nuts Data	01
Hex bolts	03
Carriage Bolts	05
Square Head Bolts	06
U Bolts	07
Cap Screws	08
Countersunk Socket Head Screw	09
Button Head screw	10
Socket Set Screws	11
Foundation Bolts	15
Threaded Rod	17
Coupling Nuts	18
Hex Nuts	19
Nylon Hex Lock nuts	21
Hex Flange Nuts	22
Domed Cap Nuts	22
Hexagon Nuts With Clamping Part	23
Wing Nuts	23
Hexagon Slotted Castle Nuts	24
Flat Washers	25
Spring Lock Washers	26
Serrated Lock Washers	27
Anchors	28
Others	28

Bolts and nuts Data

Material



Carbon Steel:
Low or Medium...



Stainless steel:
201 / 304 / 316 / 316L...



Brass



Silicon bronze



Aluminum

Finishes



White Blue Zinc Plated



Yellow Zinc Plated



White Zinc Plated



Black Zinc Plated



Nickel Plated



Hot Dip Galvanized



Black Oxide



Ruspert

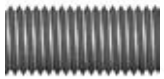

Dacromet



Black Phosphated

Identification Marks



Class 4.8



Class 8.8



Class 10.9



Class 12.9



Grade 2



Grade 5



Grade 8



307 A



307 B



307 C



AB 36



AB 55



AB 105



B8



A325



A449



B7



BC



L7



L43



A490

Size comparison table

Thread Size	M3	5#	1/8"	M4	#8	3/16"	10#	M5	M6	1/4"
Diameter	3	3.175	3.175	4	4.1656	4.7625	4.826	5	6	6.35
UNC	-	40	40	-	32	24	24	-	-	20
UNF	-	44	44	-	36	32	32	-	6	28
Coarse Pitch	0.5	0.635	0.635	0.7	0.7938	1.0583	1.0583	0.8	1	1.27
Fine Pitch	0.35	0.5773	0.5773	0.5	0.7056	0.7938	0.7938	0.5	0.5	0.9071

Thread Size	1/4"	5/16"	5/16"	M8	3/8"	3/8"	M10	7/16"	7/16"	M12
Diameter	6.35	7.9375	7.9375	8	9.525	9.525	10	11.1125	11.1125	12
UNC	20	18	18	-	16	16	-	14	14	-
UNF	26	24	22	-	24	20	-	20	18	-
Coarse Pitch	1.27	1.4111	1.4111	1.25	1.5875	1.5875	1.5	1.8143	1.8143	1.75
Fine Pitch	0.9769	1.0583	1.1545	1	1.0583	1.27	1	1.27	1.4111	1.5/1

Thread Size	1/2"	1/2"	M14	9/16"	9/16"	5/8"	5/8"	M16	M18	3/4"
Diameter	12.7	12.7	14	14.2875	14.2875	15.875	15.875	16	18	19.05
UNC	13	13	-	12	12	11	11	-	-	10
UNF	20	18	-	18	16	18	14	-	-	16
Coarse Pitch	1.9538	1.9538	2	2.1167	2.1167	2.3091	2.3091	2	2.5	2.54
Fine Pitch	1.27	1.4111	1.5	1.4111	1.5875	1.4111	1.8143	1.5	2	1.5875

Thread Size	3/4"	M20	M22	7/8"	7/8"	M24	1"	1"
Diameter	19.05	20	22	22.225	22.225	24	25.4	25.4
UNC	10	-	-	9	9	-	8	8
UNF	16	-	-	14	11	-	12	10
Coarse Pitch	2.54	2.5	2.5	2.8222	2.8222	3	3.175	3.175
Fine Pitch	1.5875	2/1.5	2	1.8143	2.3091	2/1.5	1.1167	2.54

Standards

UNI / DIN / ISO / ANSI / ASME / JIS / GB

Hex Bolts



Carbon Steel



Stainless steel

UNI 5739 - DIN 933 - ISO 4017

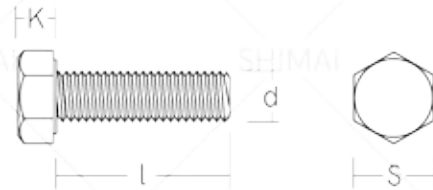

Finitura Superficiale



Zinc Plated

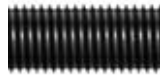

Black Oxide

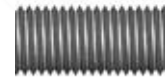

Dacromet



Black Phosphated



Hot Dip Galvanized

d	M3	M4	M5	M6	M7	M8	M10	M12	M14	M15	M18
S	5.5	7	8	10	11	13	17	19	22	24	27
K	2	2.8	3.5	4	4.8	5.3	6.4	7.5	8.8	10	11.5
l	6 - 300										

d	M20	M22	M24	M27	M30	M33	M36	M39	M42	M45	M48
S	30	32	36	41	46	50	55	60	65	70	75
K	12.5	14	15	17	18.7	21	22.5	25	26	28	30
l	6 - 300										

UNI5740 - DIN 961 - ISO 8676

d	M8x1	M10x1.25	M12x1.25	M14x1.5	M16x1.5	M18x1.5	M20x1.5	M22x1.5	M24x2	
S	13	17	19	22	24	27	30	32	36	
K	5.3	6.4	7.5	8.8	10	11.5	12.5	14	15	
l	10 - 120									

Hex Bolts



Carbon Steel



Stainless steel

UNI 5737 -DIN 931 - ISO 4014

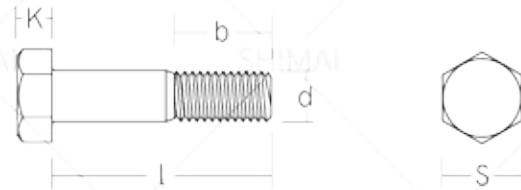

d	M4	M5	M6	M7	M8	M10	M12	M14	M16	M18	M20
S	7	8	10	11	13	17	19	22	24	27	30
K	2.8	3.5	4	4.8	5.3	6.4	7.5	8.8	10	11.5	12.5
b(l≤125)	14	16	18	20	22	26	30	34	38	42	46
b(125<l≤200)	-	22	24	26	28	32	36	40	44	48	52
b(l≥200)	-	-	-	-	-	45	49	53	57	61	65

d	M22	M24	M27	M30	M33	M36	M39	M42	M45	M48
S	32	36	41	46	50	55	50	65	70	75
K	14	15	17	18.7	21	22.5	21	26	28	30
b(l≤125)	50	54	60	66	72	78	72	-	-	-
b(125<l≤200)	36	60	66	72	78	84	78	96	102	108
b(l≥200)	69	73	79	85	91	97	103	109	115	121

UNI5738 -DIN 960 - ISO 8765

d	M8 _{x1}	M10 _{x1.25}	M12 _{x1.25}	M14 _{x1.5}	M16 _{x1.5}	M18 _{x1.5}	M20 _{x1.5}	M22 _{x1.5}	M24 _{x2}	M27 _{x2}	M30 _{x2}
S	13	17	19	22	24	27	30	32	36	41	46
K	5.3	6.4	7.5	8.8	10	11.5	12.5	14	15	17	18.7
b(l≤125)	22	26	30	34	38	42	46	50	54	60	66
b(125<l≤200)	28	32	36	40	44	48	52	56	60	66	72
b(l≥200)	41	45	49	53	57	61	65	69	73	79	85

Carriage Bolts



Carbon Steel



Stainless steel

ISO 8677 - DIN 603 - UNI 5732

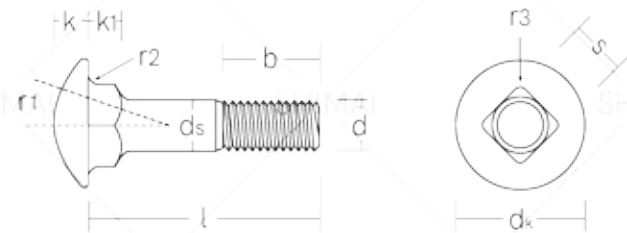

d	M5	M6	M8	M10	M12	M16	M20
Pitch	0.8	1	1.25	1.5	1.75	2	2.5
b(l≤125)	16	18	22	26	30	38	46
b(125<l≤200)	22	24	28	32	36	44	52
b(l>200)	-	-	41	45	49	57	65
dk(max)	13.55	16.55	20.65	24.65	30.65	38.8	46.8
dk(min)	12.45	15.45	19.35	23.35	29.35	37.2	45.2
ds(max)	5	6	8	10	12	16	20
ds(min)	4.52	5.52	7.42	9.42	11.3	15.3	19.16
k1(max)	4.1	4.6	5.6	6.6	8.75	12.9	15.9
k1(min)	2.9	3.4	4.4	5.4	7.25	11.1	14.1
k(max)	3.3	3.88	4.88	5.38	6.95	8.95	11.05
k(min)	2.7	3.12	4.12	4.62	6.05	8.05	9.95
r1	10.7	12.6	16	19.2	24.1	29.3	33.9
r2(max)	0.5	0.5	0.5	0.5	1	1	1
r3(max)	0.75	0.9	1.2	1.5	1.8	2.4	3
s(max)	5.48	6.48	8.58	10.58	12.7	16.7	20.84
s(min)	4.52	5.52	7.42	9.42	11.3	15.3	19.16
l	16 - 200						

Square Head Bolt



Carbon Steel



Stainless steel

DIN 21346

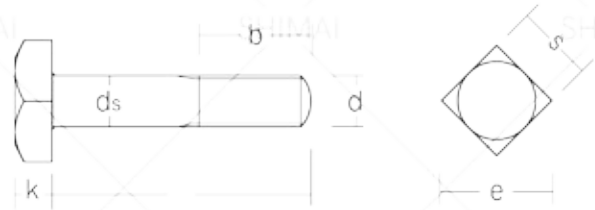

d	M16	M20	M24	M30
Pitch	2	2.5	3	3.5
b(l≤200)	36	43	53	-
b(l>200)	48	58	73	82
e	38.2	45.3	58	70.7
k	10	13	15	19
s	27	32	41	50

U Bolts

DIN 3570



Carbon Steel



Stainless steel

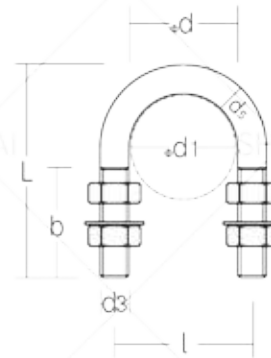

Type A

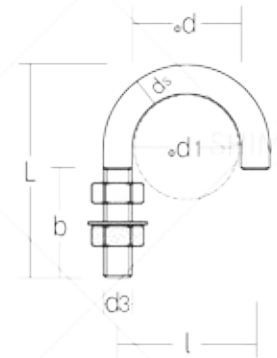

Type B

d	30	38	46	52	64	82	94	120	148
d1	25-26.9	30-33.7	38-42.4	44.5-48.3	57-60.3	76.1	88.9	108-114.3	133-139.7
b	40	40	50	50	50	50	50	60	60
ds	10	10	10	10	12	12	12	16	16
d3	M10	M10	M10	M10	M12	M12	M12	M16	M16
L	70	76	86	92	109	125	138	-	-
L1	28	31	37	40	49	57	66	171	191
n	40	48	56	62	76	94	106	136	164

d	176	202	228	282	332	378	428	530
d1	159-168.3	191-193.7	216-219.7	267-273	318-323.9	355.6-368	406.4-419	508-521
b	60	60	70	70	70	70	70	70
ds	16	16	20	20	20	24	24	24
d3	M16	M16	M20	M20	M20	M24	M24	M24
L	-	-	-	-	-	-	-	-
L1	217	249	283	334	385	435	487	589
n	192	218	248	302	352	402	452	554

Cap Screw



Carbon Steel



Stainless steel

UNI5931 - DIN 912 - ISO 4762

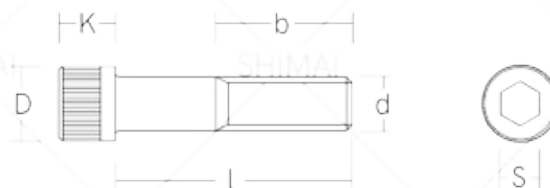

d	M3	M4	M5	M6	M8	M10	M12	M14	M16	M18	M20
D	5.5	7	8.5	10	13	16	18	21	24	27	30
K	3	4	5	6	8	10	12	14	16	18	20
S	2.5	3	4	5	6	8	10	12	14	14	17
b	18	20	22	24	28	32	36	40	44	48	52
l	6-160										

d	M22	M24	M27	M30	M33	M36	M39	M42	M45	M48
D	33	36	40	45	50	54	58	63	-	72
K	22	24	27	30	33	36	39	42	-	48
S	17	19	19	22	24	27	27	32	-	36
b	56	60	66	72	78	84	90	90	-	108
l	165-500									

UNI 9327 -DIN 7984

d	M3	M4	M5	M6	M8	M10	M12	M16
D	5.5	7	8.5	10	13	16	18	24
K	2	2.8	3.5	4	5	6	7	8
S	2	1.5	3	4	5	7	8	12
b	12	14	16	18	22	26	30	38
l	6-100							

Countersunk Socket Head Screw



Carbon Steel



Stainless steel

UNI5933 - DIN 7991

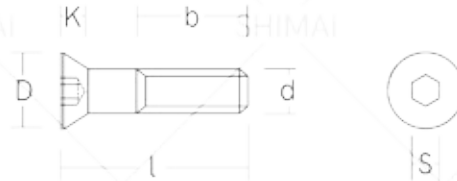

d	M3	M4	M5	M6	M8	M10	M12	M14
D	6	8	10	12	16	20	24	27
K	1.7	2.3	2.8	4.4	4.4	5.5	6.5	7
S	2	2.5	3	5	5	6	8	10
b(L≤125)	12	14	16	22	22	26	30	34
b(125<L≤200)	-	-	-	24	28	32	36	40
b(L>200)	-	-	-	-	-	45	49	55
l	6-200							

d	M16	M18	M20	M24	M30
D	30	33	36	39	-
K	7.5	8	8.5	14	-
S	10	12	12	14	-
b(L≤125)	38	42	46	54	-
b(125<L≤200)	44	48	52	60	-
b(L>200)	57	61	65	73	-
l	6-200				

button head screw



Carbon Steel



Stainless steel

ISO 7380



Finitura Superficiale



Zinc Plated



Black Oxide



Dacromet



Black Phosphated



Hot Dip Galvanized

d	M3	M4	M5	M6	M8	M10	M12
D	5.7	7.6	9.5	10.5	14	17.5	21
K	1.65	2.2	2.75	3.3	4.4	5.5	6.6
S	2	2.5	3	4	5	6	8
l	4-80						

Socket Set Screws



Carbon Steel



Stainless steel

UNI 5923 - DIN 913 - ISO 4026



Material



Carbon Steel



Stainless steel



Brass

Finitura Superficiale



Plain



Black Oxide

d	M1.6	M2	M2.5	M3	M4	M5	M6	M8	M10	M12	M14	M16	M18
S	0.7	0.9	1.3	1.5	2	2.5	3	4	5	6	6	8	10
t _{min.a}	0.7	0.8	1.2	1.2	1.5	2	2	3	4	4.8	5.6	6.4	7.2
t _{min.b}	1.5	1.7	2	2	2.5	3	3.5	5	6	8	9	10	11
l	2.5-200												

d	M20	M22	M24	M27	M30	M33	M36	M39	M42	M45	M48	M52	M56
S	10	12	12	-	-	-	-	-	-	-	-	-	-
t _{min.a}	8	9	10	-	-	-	-	-	-	-	-	-	-
t _{min.b}	12	13.5	15	-	-	-	-	-	-	-	-	-	-
l	2.5-200												

Socket Set Screws



Carbon Steel



Stainless steel

UNI 5925 - DIN 915 - ISO 4028

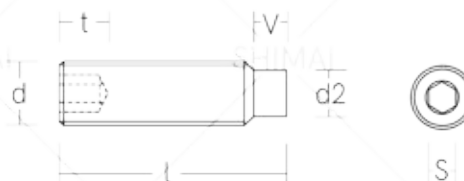

Finitura Superficiale



Plain



Black Oxide

d	M1.6	M2	M2.5	M3	M4	M5	M6	M8	M10	M12	M14	M16	M18
S	0.7	0.9	1.3	1.5	2	2.5	3	4	5	6	6	8	10
V _{min.a}	0.4	0.5	0.63	0.75	1	1.25	1.5	2	2.5	3	3.5	4	4.5
V _{min.b}	0.8	1	1.25	1.5	2	2.5	3	4	5	6	7	8	9
d2	0.8	1	1.5	2	2.5	3.5	4	5.5	7	8.5	10	12	13
t _{min.a}	0.7	0.8	1.2	1.2	1.5	2	2	3	4	4.8	5.6	6.4	7.2
t _{min.b}	1.5	1.7	2	2	2.5	3	3.5	5	6	8	9	10	11
l	2.5-200												

d	M20	M22	M24	M27	M30	M33	M36	M39	M42	M45	M48	M52	M56
S	10	12	12	-	-	-	-	-	-	-	-	-	-
V _{min.a}	5	5.5	6	-	-	-	-	-	-	-	-	-	-
V _{min.b}	10	11	12	-	-	-	-	-	-	-	-	-	-
d2	15	17	18	-	-	-	-	-	-	-	-	-	-
t _{min.a}	8	9	10	-	-	-	-	-	-	-	-	-	-
t _{min.b}	12	13.5	15	-	-	-	-	-	-	-	-	-	-
l	2.5-200												

Socket Set Screws



Carbon Steel



Stainless steel

UNI 5927 - DIN 914 - ISO 4027

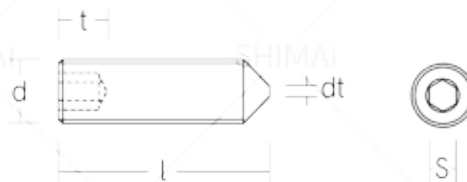

Material



Carbon Steel



Stainless steel



Brass

Finitura Superficiale



Plain



Black Oxide

d	M1.6	M2	M2.5	M3	M4	M5	M6	M8	M10	M12	M14	M16	M18
S	0.7	0.9	1.3	1.5	2	2.5	3	4	5	6	6	8	10
t _{min.a}	0.7	0.8	1.2	1.2	1.5	2	2	3	4	4.8	5.6	6.4	7.2
t _{min.b}	1.5	1.7	2	2	2.5	3	3.5	5	6	8	9	10	11
dt _{max.}	0.16	0.20	0.25	0.3	0.4	0.5	1.5	2	2.5	3	4	4	5
l	2.5-200												

d	M20	M22	M24	M27	M30	M33	M36	M39	M42	M45	M48	M52	M56
S	10	12	12	-	-	-	-	-	-	-	-	-	-
t _{min.a}	8	9	10	-	-	-	-	-	-	-	-	-	-
t _{min.b}	12	13.5	15	-	-	-	-	-	-	-	-	-	-
dt _{max.}	5	6	6	-	-	-	-	-	-	-	-	-	-
l	2.5-200												

Socket Set Screws



Carbon Steel



Stainless steel

UNI 5929 - DIN 916 - ISO 4029

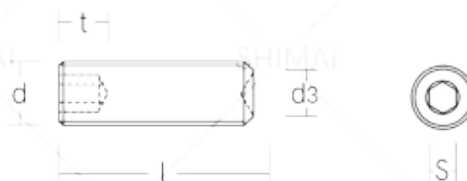

Material



Carbon Steel



Stainless steel



Brass

Finitura Superficiale



Plain



Black Oxide

d	M1.6	M2	M2.5	M3	M4	M5	M6	M8	M10	M12	M14	M16	M18
S	0.7	0.9	1.3	1.5	2	2.5	3	4	5	6	6	8	10
t _{min.a}	0.7	0.8	1.2	1.2	1.5	2	2	3	4	4.8	5.6	6.4	7.2
t _{min.b}	1.5	1.7	2	2	2.5	3	3.5	5	6	8	9	10	11
d ₃	0.8	1	1.2	1.4	2	2.5	3	5	6	7	8.5	10	11
l	2.5-200												

d	M20	M22	M24	M27	M30	M33	M36	M39	M42	M45	M48	M52	M56
S	10	12	12	-	-	-	-	-	-	-	-	-	-
t _{min.a}	8	9	10	-	-	-	-	-	-	-	-	-	-
t _{min.b}	12	13.5	15	-	-	-	-	-	-	-	-	-	-
d ₃	13	15	16	-	-	-	-	-	-	-	-	-	-
l	2.5-200												

Foundation Bolts



Hot Dip Galvanized



Black Oxide

Type A

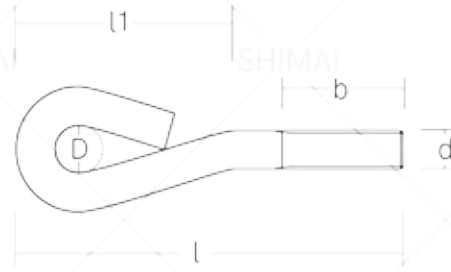

d	M8	M10	M12	M16	M20	M24	M30	M36	M42	M48	M56	M64	M72
Pitch	1.25	1.5	1.75	2	2.5	3	3.5	4	4.5	5	5.5	6	6
b	31	36	40	50	58	68	80	94	106	120	140	160	180
l ₁	46	65	82	93	127	139	192	244	261	302	343	385	430
D	10	15	20	20	30	30	45	60	60	70	80	90	100



Hot Dip Galvanized



Black Oxide

Type B

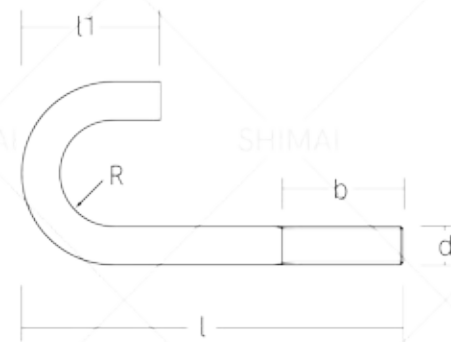

d	M8	M10	M12	M16	M20	M24	M30	M36	M42	M48	M56	M64	M72
Pitch	1.25	1.5	1.75	2	2.5	3	3.5	4	4.5	5	5.5	6	6
b	31	36	40	50	58	68	80	94	106	120	140	160	180
l ₁	48	60	72	96	120	144	180	216	252	288	336	384	432
R	16	20	24	32	40	48	60	72	84	96	112	128	144

Foundation Bolts



Hot Dip Galvanized



Black Oxide

Type C



d	M8	M10	M12	M16	M20	M24	M30	M36	M42	M48	M56	M64	M72
Pitch	1.25	1.5	1.75	2	2.5	3	3.5	4	4.5	5	5.5	6	6
b	31	36	40	50	58	68	80	94	106	120	140	160	180
l ₁	32	40	48	64	80	96	120	144	168	192	224	256	288
R	16	20	24	32	40	48	60	72	84	96	112	128	144

Threaded Rod



Carbon Steel



Stainless steel

DIN 975

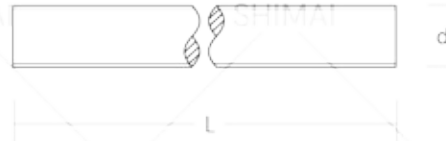

	d	M2	M2.5	M3	M3.5	M4	M5	M6	M8	M10	M12	M14	M16	M18
	fine pitch	-	-	-	-	-	-	-	1	1.25	1.5	1.5	1.5	1.5
P	fine pitch	-	-	-	-	-	-	-	-	1	1.25	-	-	-
	coarse pitch	0.4	0.45	0.5	0.6	0.7	0.8	1	1.25	1.5	1.75	2	2	2.5
	L (±10)	1000	1000	1000	1000	1000	1000	1000	1000	1000	1000	1000	1000	1000

	d	M20	M22	M24	M27	M30	M33	M36	M39	M42	M45	M48	M52
	fine pitch	1.5	1.5	2	2	2	2	3	3	3	3	3	3
P	fine pitch	-	-	-	-	-	-	-	-	-	-	-	-
	coarse pitch	2.5	2.5	3	3	3.5	3.5	4	4	4.5	4.5	5	5
	L (±10)	1000	1000	1000	1000	1000	1000	1000	1000	1000	1000	1000	1000

DIN 976 - UNI 6547

	d	M2	M2.5	M3	M3.5	M4	M5	M6	M8	M10	M12	M14	M16	M18	M20	M22
	fine pitch	-	-	-	-	-	-	-	1	1.25	1.5	1.5	1.5	1.5	1.5	1.5
P	fine pitch	-	-	-	-	-	-	-	-	1	1.25	-	-	-	-	-
	coarse pitch	0.4	0.45	0.5	0.6	0.7	0.8	1	1.25	1.5	1.75	2	2	2.5	2.5	2.5
	L	5-3000														

	d	M24	M27	M30	M33	M36	M39	M42	M45	M48	M52	M56	M60	M64	M68	M72
	fine pitch	2	2	2	2	3	3	3	3	3	3	4	4	4	4	6
P	fine pitch	-	-	-	-	-	-	-	-	-	-	-	-	-	-	-
	coarse pitch	3	3	3.5	3.5	4	4	4.5	4.5	5	5	5.5	5.5	6	6	-
	L	5-3000														

Coupling Nuts



Carbon Steel



Stainless steel

DIN 6334

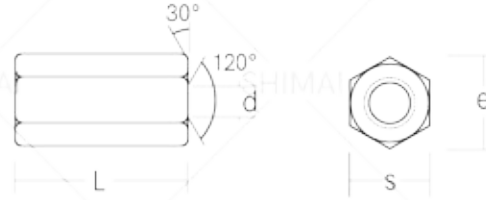

d	M6	M8	M10	M12	M14	M16	M18	M20	M22	M24	M27	M30	M33	M36
Pitch	1	1.25	1.5	1.75	2	2	2.5	2.5	2.5	3	3	3.5	3.5	4
s	10	13	17	19	22	24	27	30	32	36	41	46	50	55
L	18	24	30	36	42	48	54	60	66	72	81	90	99	108
e	11.05	14.38	18.9	21.1	24.49	26.75	29.56	33.53	35.03	39.98	45.2	50.85	55.37	60.79



Carbon Steel



Stainless steel



d	M5	M6	M8	M10	M12	M14	M16
dk	10	10	12	16	18	20	24
	8	8	20	20	25	30	30
L	10	10	25	25	30		
	15	15	30	30	40		
	20	20	40	40	50		

Hex Nuts



Carbon Steel



Stainless steel

UNI 5587

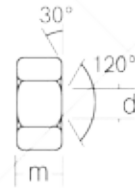

d	M3	M4	M5	M6	M7	M8	M10	M12	M14	M16	M18	M20	M22	M24
Coarse Pitch	0.5	0.7	0.8	1	1	1.25	1.5	1.75	2	2	2.5	2.5	2.5	3
Fine Pitch	0.35	0.5	0.5	0.75	0.75	1	1.25	1.25	1.5	1.5	1.5	1.5	1.5	2
S	5.5	7	8	10	11	13	17	19	24	24	27	30	32	36
m	3	4	5	6	7	8	10	12	16	16	18	20	22	24

d	M27	M30	M33	M36	M39	M42	M45	M48	M52	M56	M60	M64	M68	M72
Coarse Pitch	3	3.5	3.5	4	4	4.5	4.5	5	5	5.5	5.5	6	6	6
Fine Pitch	2	2	2	3	3	3	3	3	3	4	4	4	4	4
S	41	46	50	55	60	65	70	75	80	85	90	95	100	105
m	27	30	33	36	39	42	45	48	52	56	60	64	68	72



Carbon Steel



Stainless steel

UNI 5588 - DIN 934

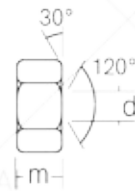

d	M3	M4	M5	M6	M7	M8	M10	M12	M14	M16	M18	M20	M22	M24
Coarse Pitch	0.5	0.7	0.8	1	1	1.25	1.5	1.75	2	2	2.5	2.5	2.5	3
Fine Pitch	0.35	0.5	0.5	0.75	0.75	1	1.25	1.25	1.5	1.5	1.5	1.5	1.5	2
S	5.5	7	8	10	11	13	17	19	24	24	27	30	32	36
m	2.4	3.2	4	5	5.5	6.5	8	10	11	13	15	16	18	19

d	M27	M30	M33	M36	M39	M42	M45	M48	M52	M56	M60	M64	M68	M72
Coarse Pitch	3	3.5	3.5	4	4	4.5	4.5	5	5	5.5	5.5	6	6	6
Fine Pitch	2	2	2	3	3	3	3	3	3	4	4	4	4	4
S	41	46	50	55	60	65	70	75	80	85	90	95	100	105
m	22	24	26	29	31	34	36	38	42	45	48	51	54	58

Hex Nuts



Carbon Steel



Stainless steel

UNI 5589 - DIN 936

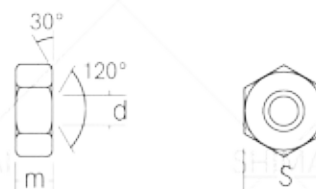

d	M5	M6	M7	M8	M10	M12	M14	M16	M18	M20	M22	M24	M27	M30
Coarse Pitch	0.8	1	1	1.25	1.5	1.75	2	2	2.5	2.5	2.5	3	3	3.5
Fine Pitch	0.5	0.75	0.75	1	1.25	1.25	1.5	1.5	1.5	1.5	1.5	2	2	2
S	8	10	11	13	17	19	22	24	27	30	32	36	41	46
m	3.5	4	4	5	6	7	8	8	9	9	10	10	12	12

d	M33	M36	M39	M42	M45	M48	M52	M56	M60	M64	M68	M72	M76	M80
Coarse Pitch	3.5	4	4	4.5	4.5	5	5	5.5	5.5	6	6	6	6	6
Fine Pitch	2	3	3	3	3	3	3	4	4	4	4	4	4	4
S	50	55	60	65	70	75	80	85	90	95	100	105	110	115
m	14	14	16	16	18	18	20	22	24	26	26	28	30	32



Carbon Steel



Stainless steel

UNI 5713 - DIN 6915



d	M12	M14	M16	M18	M20	M22	M24	M27	M30
b	20	22	25	28	30	34	39	43.5	55.5
m	10	11	13	15	16	18	19	22	24
s	22	24	27	30	32	36	41	46	49

Nylon Hex Lock Nut



Carbon Steel



Stainless steel

DIN 982

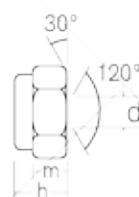

d	M3	M4	M5	M6	M8	M10	M12	M14	M16	M18
Coarse Pitch	0.5	0.7	0.8	1	1.25	1.5	1.75	2	2	2.5
Fine Pitch	-	-	-	-	1	1.25	1.25	1.5	1.5	1.5
S	5.5	7	8	10	13	17	19	22	24	27
h	-	6	6.3	8	9.5	11.5	14	16	18	20
m	-	3.2	4.4	4.9	6.44	8.04	10.37	12.1	14.1	15.1

d	M20	M22	M24	M27	M30	M33	M36	M39	M42	M45
Coarse Pitch	2.5	2.5	3	3	3.5	3.5	4	4	4.5	4.5
Fine Pitch	1.5	2	2	2	2	2	3	3	3	3
S	30	32	36	41	50	50	55	60	65	70
h	22	25	28	30.8	36	36	40	42	45	48
m	16.9	18.1	20.2	21.6	26.4	26.4	28.8	31.2	33	36

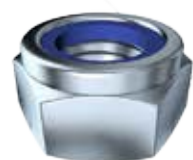

Carbon Steel



Stainless steel

DIN 985

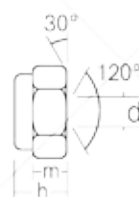

d	M3	M4	M5	M6	M8	M10	M12	M14	M16	M18
Coarse Pitch	0.5	0.7	0.8	1	1.25	1.5	1.75	2	2	2.5
Fine Pitch	-	-	-	-	1	1.25	1.25	1.5	1.5	1.5
S	5.5	7	8	10	13	17	19	22	24	27
h	4	5	5	6	8	10	12	14	16	18.5
m	2.4	2.9	3.2	4	5.5	6.5	8	9.5	10.5	13

d	M20	M22	M24	M27	M30	M33	M36	M39	M42	M45
Coarse Pitch	2.5	2.5	3	3	3.5	3.5	4	4	4.5	4.5
Fine Pitch	1.5	2	2	2	2	2	3	3	3	3
S	30	32	36	41	46	50	55	60	65	70
h	20	22	27	27	30	33	36	39	42	45
m	14	15	17	17	19	22	25	27	29	32

Hexagon Flange Nuts

DIN 6923 - ISO 4161



Carbon Steel



Stainless steel

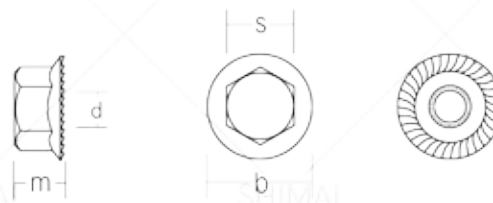

d	M4	M5	M6	M8	M10	M10	M12	M14	M16	M20
Coarse Pitch	0.7	0.8	1	1.25	1.5	1.5	1.75	2	2	2.5
S	7	8	10	13	15	17	18	21	24	30
m	4.5	5	6	8	10	10	12	14	16	20
b	9.9	11.8	14.2	17.9	21.8	21.8	26	29.9	34.5	42.8

Domed Cap Nuts

UNI 5721 - DIN 1587



Carbon Steel



Stainless steel

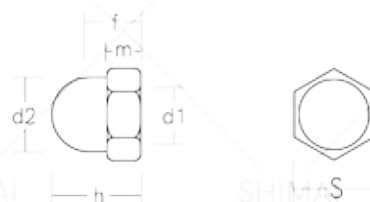

d	M4	M5	M6	M8	M10	M12	M14	M16	M20
Coarse Pitch	0.7	0.8	1	1.25	1.5	1.75	2	2	2.5
S	7	8	10	13	17	19	22	24	30
h	8.5	11	13	16	19	22	25	28	34
d2	6.5	7.5	9.5	12.5	16	18	21	23	29
f	5	7	8	11	13	16	18	21	26
m	3.2	4	5	6.5	8	10	11	13	16

Hexagon Nuts With Clamping Part



Carbon Steel



Stainless steel

DIN 980

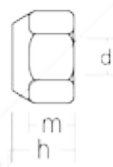

d	M5	M6	M8	M10	M12	M14	M16	M18	M20	M22	M24	M27	M30
Coarse Pitch	0.8	1	1.25	1.5	1.75	2	2	2.5	2.5	2.5	3	3	3.5
Fine Pitch	-	-	-	-	-	1.5	1.5	1.5	-	-	-	-	-
S	8	10	13	17	19	22	24	27	30	32	36	41	46
h	5	6	8	10	12	14	16	18	20	22	24	27	30

Wing Nuts



Carbon Steel



Stainless steel

UNI5448- TIPO A- DIN 315

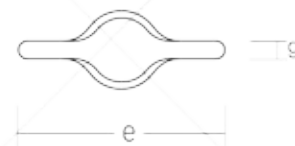
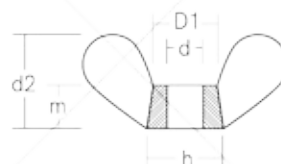

d	M3	M4	M5	M6	M8	M10	M12	M14	M16
Coarse Pitch	0.5	0.5	0.7	0.8	1	1.25	1.5	1.75	2
D1	5.2	5.2	5.2	6.7	8.4	9.1	11	15	18
D2	8	8	8	10.3	12.7	13.8	16.5	22.5	26.6
e	17.6	17.6	17.6	22.5	27.8	30.3	36.2	49.4	58.3
g	1.6	1.6	1.6	2.1	2.5	2.8	3.3	4.5	5.2
h	8.6	8.6	8.6	11	13.6	14.8	17.7	24.1	28.5
m	3.5	3.5	3.5	4.1	5.1	5.6	6.8	9	10.7

Hexagon Slotted Castle Nuts



Carbon Steel



Stainless steel

UNI 5593 - DIN 935

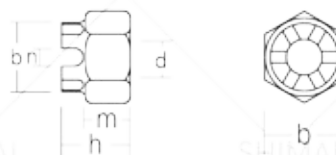

d	M8	M10	M12	M14	M16	M18	M20	M22	M24	M27	M30	M33	M36	M39
Coarse Pitch	1.25	1.5	1.75	2	2	2.5	2.5	2.5	3	3	3.5	3.5	4	4
Fine Pitch	1	1.25	1.25	1.5	1.5	1.5	1.5	1.5	2	2	2	2	3	3
S	13	17	19	22	24	27	30	32	36	41	46	50	55	60
b	-	-	17	19	22	25	28	30	34	38	42	46	50	55
n	2.5	2.8	3.5	3.5	4.5	4.5	4.5	5.5	5.5	5.5	7	7	7	7
m	6.5	8	10	11	13	15	16	18	19	22	24	26	29	31
h	9.5	12	15	16	19	21	22	26	27	30	33	35	38	40



Carbon Steel



Stainless steel

UNI 5594



d	M8	M10	M12	M14	M16	M18	M20	M22	M24	M27	M30	M33	M36	M39
Coarse Pitch	1.25	1.5	1.75	2	2	2.5	2.5	2.5	3	3	3.5	3.5	4	4
Fine Pitch	1	1.25	1.25	1.5	1.5	1.5	1.5	1.5	2	2	2	2	3	3
S	13	17	19	22	24	27	30	32	36	41	46	50	55	60
b	-	-	17	19	22	25	28	30	34	38	42	46	50	55
n	2.5	2.8	3.5	3.5	4.5	4.5	4.5	5.5	5.5	5.5	7	7	7	7
m	5	6	7	8	8	9	9	10	10	12	12	14	14	16
h	8	10	12	13	14	15	15	18	18	20	21	23	23	25

Flat Washers



Carbon Steel



Stainless steel

UNI 6592 - DIN 125-A - IOS 7089

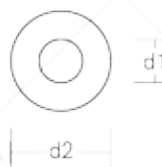

Φ	M3	M3	M4	M4	M5	M5	M6	M6	M7	M8	M8	M10	M10	M12	M12	M14	M16
d1	-	-	4.3	4.3	5.3	5.3	6.4	6.4	7.4	8.4	8.4	10.5	10.5	13	13	15	17
d2	6	7	8	9	9.5	10	11	12	14	14	16	18	20	20	24	28	30
s	-	-	0.8	0.8	1	1	1.6	1.6	1.6	1.6	1.6	2	2	2.5	2.5	2.5	3

Φ	M18	M20	M22	M24	M27	M30	M33	M36	M39	M42	M45	M48	M52	M56	M58	M60	M64
d1	19	21	23	25	27	31	34	37	40	43	46	50	54	58	60	62	66
d2	34	37	39	44	50	56	60	66	72	78	85	92	98	105	110	110	115
s	3	3	3	4	4	4	5	5	6	7	7	8	8	9	9	9	9



Carbon Steel



Stainless steel

UNI 6593 - DIN 9021 - IOS 7093

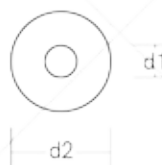

Φ	M3	M4	M4	M5	M5	M6	M6	M7	M7	M8	M8	M9	M9	M10	M10
d1	3.2	4.3	4.3	5.3	5.3	6.4	6.4	7.6	7.6	8.4	8.4	9.6	9.6	10.5	10.5
d2	9	12	16	15	20	18	24	21	28	24	32	27	38	30	40
s	0.8	1	1	1.2	1.2	1.6	1.6	2	2.5	3.2	6.5	2.5	2.5	2.5	2.5

Φ	M12	M12	M14	M14	M16	M16	M18	M18	M20	M20	M22	M24	M27	M30
d1	13	13	15	15	17	17	20	20	21	21.5	23	25	30	33
d2	37	48	36	44	50	64	56	72	60	80	66	72	81	90
s	3	3	3	3	3	3	4	4	4	5	5	5	6	6

Spring Lock Washers

UNI 1751 - TIPO A



Carbon Steel



Stainless steel

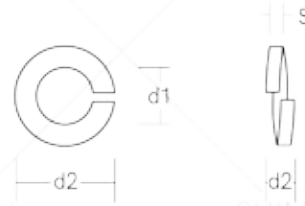

Φ	M3	M4	M5	M6	M7	M8	M10	M12	M14	M16
d1	3.2	4.2	5.3	6.4	7.4	8.4	10.5	13	15	17
d2	5.8	7.3	8.9	11.4	12.4	14.4	17.5	21	24	27
s	0.8	0.9	1.2	1.6	2	2.2	2.5	3	3.5	3.5
h	1.6	1.8	2.4	3.2	3.2	4	4.4	5	6	7

Φ	M18	M20	M22	M24	M27	M30	M33	M36	M39	M42
d1	19	21	23	25	28	31	34	37	40	43
d2	29	33	35	39	42	47	54	57	60	68
s	4	4	5	5	6	6	6	6	6	7
h	7	8	8	10	10	12	12	12	12	17

DIN 127 - TIPO B



Carbon Steel



Stainless steel

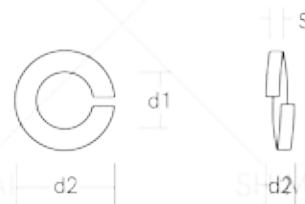

Φ	M3	M4	M5	M6	M7	M8	M10	M12	M14	M16	M18
d1	3.1	4.1	5.1	6.1	7.1	8.1	10.2	12.2	14.2	16.2	18.2
d2	6.2	7.6	9.2	11.8	12.8	14.8	18.1	21.1	24.1	27.4	29.4
s	0.8	0.9	1.2	1.6	1.6	2	2.2	2.5	3	3.5	3.5
h	1.6	1.8	2.4	3.2	3.2	4	4.4	5	6	7	7

Φ	M20	M22	M24	M27	M30	M33	M36	M39	M42	M45	M48
d1	20.2	22.5	24.5	27.5	30.5	33.5	36.5	39.5	43	46	49
d2	33.6	35.9	40	43	48.2	55.2	58.2	61.2	66	69	72
s	4	4	5	5	6	6	6	6	7	7	7
h	8	8	10	10	12	12	12	12	13	13	13

Serrated Lock Washers



Carbon Steel



Stainless steel

UNI 8842-A - DIN 6798-A



d1

d2



s

≈3s

d	M3	M3.5	M4	M5	M6	M7	M8	M10	M12	M14	M16	M18	M20	M22	M24
d1	3.2	3.7	4.3	5.3	6.4	7.4	8.4	10.5	12.5	14.5	16.5	19	21	23	25
d2	6	7	8	10	11	12.5	15	18	20.5	24	26	30	33	36	38
s	0.4	0.5	0.5	0.6	0.7	0.8	0.8	0.9	1	1	1.2	1.4	1.4	1.5	1.5
min. number of teeth	9	10	11	11	12	14	14	16	16	18	18	18	20	20	20



Carbon Steel



Stainless steel

UNI 8842-J - DIN 6798-J



d1

d2



s

≈3s

d	M3	M3.5	M4	M5	M6	M7	M8	M10	M12	M14	M16	M18	M20	M22	M24
d1	3.2	3.7	4.3	5.3	6.4	7.4	8.4	10.5	12.5	14.5	16.5	19	21	23	25
d2	6	7	8	10	11	12.5	15	18	20.5	24	26	30	33	36	38
s	0.4	0.5	0.5	0.6	0.7	0.8	0.8	0.9	1	1	1.2	1.4	1.4	1.5	1.5
min. number of teeth	7	8	8	8	9	10	10	12	12	14	14	14	16	16	16

Anchor



Wedge Anchor

size: M6-M24



Anchor Bolt

size: M5-M20



Drop in Anchor

size: M6-M20



Cut Anchor

size: M6-M20

Other



Lag Screw

size: M4-M20



Double Head Bolt

size: M10-M56



Dowel screw

size: M4-M10



Hanger bolt

size: M4-M10



Roofing bolt

size: M4-M8

Packaging & Shipping



Color box



White box



Brown box

About delivery

For hex bolt orders with a total order of less than 30 tons, if there are no special circumstances, we will ship within 20 days after ordering

Packaging details

1. We have several sizes of packing dimensions, can be 20kg or 25kg per carton.
2. For large orders, we can design specific sizes of boxes and cartons.
3. Normal Packing: small boxes into cartons.
4. Can provide special packings as middle east clients requests.

Company Profile

Our company "Shimai" is an advanced manufacturer with import and export rights in fastener business. We introduces Taiwan's advanced production equipment and superb technology, then has a series of advanced professional screw production lines. Our main products are screws, rivets, nails, anchor, bolts, nuts, Circlips, Washers, Studs, bits, pins and hardware tools. With more than 10,000 tons of annual production, we serve various industries and fields at home and abroad. At the same time, our company is committed to the development of stainless steel screws, and more high-precision, high-quality screws and established long-term good business relations with Europe, America, Southeast Asia, Middle East and other countries customers.

With the principle of "excellence quality first, integrity management, customer first", our company is in strict management, high-quality production, high-precision inspection and high standard service.

We has passed the EU quality management system certification-CE and get SGS certificate, So quality guaranteed. With over 10 years experience of exporting, we have the ability to meet customer's needs and wants and we are making great efforts to make win-win situation. Sincerely welcome you to join us!

Company Advantage

1) Best Service :

We provide 24 hours online service for dealing with customer's inquiries and solve customer's problems at the first time.

2) Professional Team :

Our team has more than 20 years of experience. All products are developed and designed by ourselves.

3) Technical Section :

Technical support is provided by professional technicians to ensure that the drawings are precise and accurate.

4) Factory direct sale :

You can get direct factory price from us.

Product Advantages

1) High Quality

2) Timely Delivery Guaranteed

3) Model Customization

4) Technical Controlling

5) Precision Machining

6) Complete model



Shimai Industrial Co., Limited

Wangwenzhuang Industrial Park, Xiqing District, Tianjin, China

Tangshan Shimai Imp & Exp Trading Co.,Ltd

No.118, Bldg.9, Tongda Building Materials Exhibition City, Fengnan Development Area, Tangshan, Hebei, China

Tel/Fax: 0086 315 8117672

Mobile/Whatsapp/Wechat: 0086 13012299116

Mail: suli@shimai-hardware.com

www.shimaifastener.com